



Start, Accelerate, Grow! Co-innovate Your Business in the Heart of Tokyo.



x Bridge-Tokyo

STARTUP STUDIO

Launch your business only minutes from megahub Tokyo Station and three subway stations in Japan's historic Yaesu-Nihonbashi-Kyobashi district. From Day One, you are part of a community of people and companies rich in know-how and connections. Opened in April 2018, xBridge-Tokyo is much more than a shared office. This is truly a bridge between people and between startups and area industries with experience measured in centuries. With the support of mentoring enterprises, our open innovation model will support the continuous creation and dynamic growth of business. Growing together with startup members, xBridge-Tokyo aims to re-ignite the area's development as a leading innovation base in Japan and the world. We invite you to lay the cornerstone of your business in xBridge-Tokyo and join us in shaping future of Nihonbashi.



Meeting Space



Work Space



Bar Counter



Personal Locker

FLOOR MAP

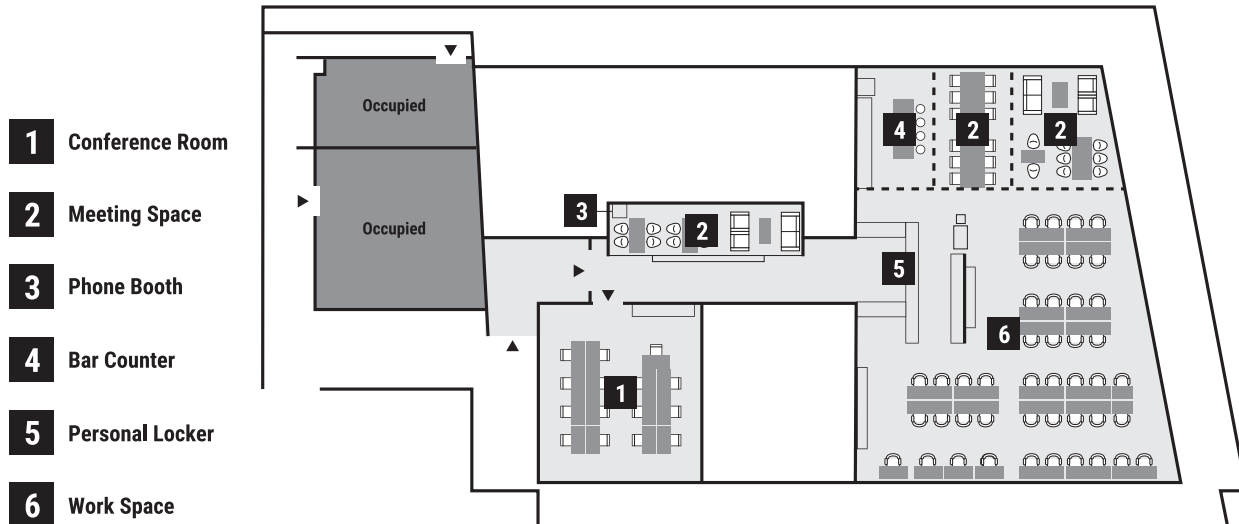

OUTLINE

Facility Name: xBridge Tokyo (“Cross Bridge Tokyo”)

Address: TG Building 8F, 1-2-16 Yaesu, Chuo-ku Tokyo 103-0028

No. of Seats: approx. 40 seats (all assigned seating)

Usage Fee: JPY22,000 per seat (inclusive of tax)
* Includes usage of Wi-Fi, a personal locker, shared meeting space, MFP usage, various office consumables, and more.

Contract: Minimum 1-year contract in principle (up to 8 seats per company).

Scope of Usage: Usage as registered head office.

Seats Per Member: 1~8 seats (After move-in, possible increase to a max. of 8 seats subject to availability)

Applicant Qualifications: The individual or company should target remarkable growth as a startup and support the aim of making the Yaesu-Nihonbashi-Kyobashi area a center of innovation.

CURRENT MEMBERS



ACCESS

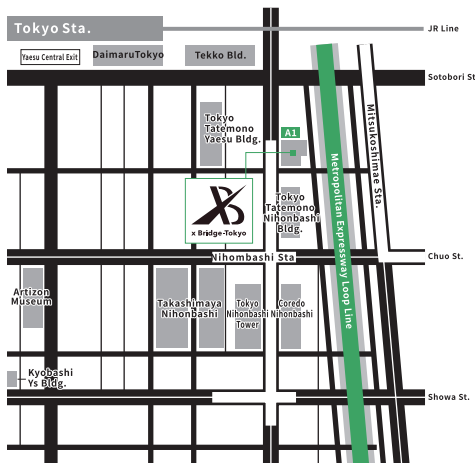

NIHONBASHI STATION
1-minute walk from Nihonbashi Station (Exit A1)
(Tokyo Metro Ginza and Tozai Lines / Toei Asakusa Line)

TOKYO STATION
3-minute walk from Tokyo Station (Nihonbashi Exit)
(JR Shinkansen (Bullet Train) Lines: Tokaido-Sanyo, Tohoku-Hokkaido, Yamagata, Akita, Jo-etsu, and Hokuriku / JR Urban & Intercity Lines: Yamanote, Keihin-Tohoku, Chuo, Tokaido(Main Line), Takasaki, Utsunomiya, Musashino, Keiyo, Sobu (Rapid), Yokosuka, Joban and Ueno-Tokyo Lines / Tokyo Metro: Marunouchi)

OTEMACHI STATION
9-minute walk from Otemachi Station
(Tokyo Metro Marunouchi, Tozai, Chiyoda, and Hanzomon Lines / Toei Mita Line)

MITSUKOSHIMAE STATION
3-minute walk from Mitsukoshimae Station
(Tokyo Metro Ginza & Hanzomon Lines)



■ Access Map
*Travel times are estimates of the shortest possible time during normal daytime hours and do not include time for changing trains or waiting.



Area Development Department
Tokyo Tatemono Co., Ltd.
Land, Infrastructure, Transport and Tourism Minister License (16) No.6 / Japan Building Owners and Managers Association Member
1-4-16 Yaesu, Chuo-ku, Tokyo 103-8285

For more information:
<https://xbridge.tokyo/>
TEL 03-3274-0961
(Area Development Department)
E-MAIL xBridge-Tokyo@tatemono.com



Office Space Solution for Startups Make Your Move at xBRIDGE-TOKYO NEXT

Security deposits, interior work, office furniture purchases, restoration of the former premises to original condition, and scheduling labor for the move... For new startups with tight budgets and endless demands on their time, moving into new office premises can be overwhelming. Ready for business with finished interiors and furnished with the essentials, xBridge-Tokyo Next office space for startups lightens the burden and frees entrepreneurs to concentrate on the important task of growing their business. In April 2020, the first location of an office platform optimized for startups opened in Kyobashi, Chuo-ku.

x
Bridge
Tokyo
Next

FURNISHED OFFICE FOR STARTUPS

Stairway

Room2

Room1

FLOOR MAP

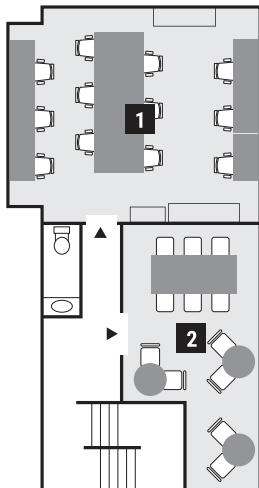

1
Room1
Room for rent
① 37.37㎡

2
Room2
Room for rent
② 21.78㎡

* Work Room diagram shows an example of an interior layout. Furniture can be moved /rearranged.

OUTLINE

Facility Name: xBridge-Tokyo Next ("Cross Bridge Tokyo Next")

Address: 3-6-10 Kyobashi, Chuo-ku Tokyo 104-0031

Offices for Lease: Total 4 units

Lease Fee: Contact us for details

Contract Conditions:

- Furnished Office Space (Desks, Chairs, Lockers)
- MFP usage, Wi-Fi service, Utilities (water, heat, lighting, etc.), and Cleaning Service fees are included in the monthly lease fee.
- Conference Room (Private Room): 1
- In principle, tenant's head office registration at this address (no charge for registration)
- Security Deposit: Equivalent to 1 month's rent

Applicant Qualifications: The individual or company should target remarkable growth as a startup and support the aim of making the Yaesu-Nihonbashi-Kyobashi area a center of innovation.

CURRENT MEMBERS

TOKYO
IDEA
EXCHANGE

PLANT

ACCESS

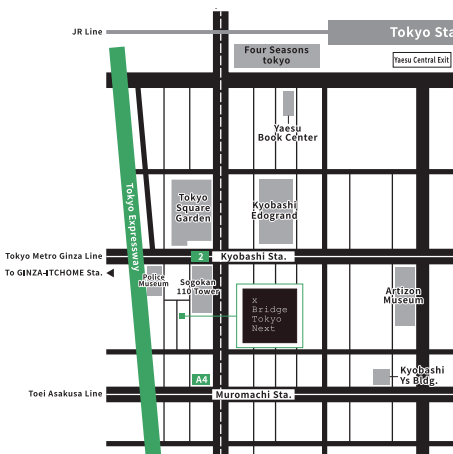

KYOBASHI STATION

2-minute walk from Kyobashi Station (Exit No. 2)
(Tokyo Metro Ginza Line)

TAKARACHO STATION

2-minute walk from Takaracho Station (Exit A4)
(Toei Asakusa Line)

TOKYO STATION

9-minute walk from Tokyo Station
(JR Shinkansen (Bullet Train) Lines: Tokaido-Sanyo, Tohoku-Hokkaido, Yamagata, Akita, Jo-etsu, and Hokuriku /JR Urban & Intercity Lines: Yamanote, Keihin-Tohoku, Chuo, Tokaido(Main Line), Takasaki, Utsunomiya, Musashino, Keiyo, Sobu (Rapid), Yokosuka, Joban and Ueno-Tokyo Lines/ Tokyo Metro: Marunouchi)

GINZA-ITCHOME STATION

3-minute walk from Ginza-Itchome Station
(Tokyo Metro Yurakucho Line)



■ Access Map

*Travel times are estimates of the shortest possible time during normal daytime hours and do not include time for changing trains or waiting.

TOKYO TATEMONO

Area Development Department
Tokyo Tatemono Co., Ltd.

Land, Infrastructure, Transport and Tourism Minister
License (16) No.6 / Japan Building Owners and Managers
Association Member
1-4-16 Yaesu, Chuo-ku, Tokyo 103-8285

For a lease application form,
please scan this QR code

For more information, please call or e-mail:
TEL 03-3274-0961

(Area Development Department)
E-MAIL xBridge-Tokyo@tatemono.com



+OURS Yaesu

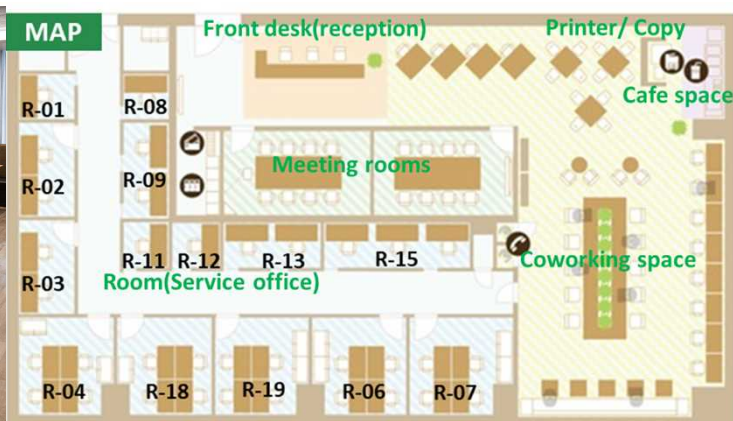

ACCESS

Tokyo Tatemono Yaesu Bldg.3F 1-4-16,Yaesu,Chuo-ku,Tokyo, Japan 103-0028

Tokyo Station 4min. Nihonbashi Station 1min.



	Service Office Member	Coworking Member	Service	Service Office Member	Coworking Member
Member type	Room	Monthly Member (Full Time)	Serving visitors We will give you a call when visitors arrive.	●	●
Usage Fee	inquire	¥22,000 / month	Mail receiving We will deliver the mail received to member's mailbox. *Some exception.	●	● For address option or registration option
Available Time	24 hours *Coworking area: Mon.-Fri.8:00~20:00	Mon.-Fri. 8:00~20:00	Package receiving We will pick up your package and deliver it to the office. *Some exception.	●	—
Initial cost	2 months usage fee	¥22,000	Letter mailing We will send out posted mail dropped off at the front desk the same day.	●	●
Advanced Payments	The first payments is the total of the daily rate for the first month along with monthly rate of the following month.		Keep luggage We will temporarily store luggage waiting for pickup at the front desk. *Member must contract with delivery company on their own.	●	—
[Optional service] For registration	To use our address for corporate and commercial registration.		Meeting room Please reserve meeting room every 30 minutes. *A projector is available in the room A. *A monitor is available in the room B. *Room A and B can be connected.	●	●
[Optional service] Use as a corporate address	Free	+¥22,000 / month		4hours per month for free.	8pax, 4,400yen/hour 16pax, 8,800yen/hour
	Free	+¥11,000 / month			

※All prices include consumption tax

+OURS information center

tomoru inc. Yoyogi Seminar Bldg. 1-29-1, Yoyogi, Shibuya-ku, Tokyo
License : Real Estate (1) 102256 issued by Governor of Tokyo

Call : 03-6555-2047

✉ : ours@tomoru.co.jp